

#### USE AND MAINTENANCE

Use on level surfaces only  
Because this product needs assembly, it is prone to working itself loose from time to time depending on the use. Please take the time to check that all connections are still tight and working properly  
Only clean using a damp cloth and mild detergent, do not use bleach or abrasive cleaners.

## Claire Accent Chair

### PART LIST



1 - Chair Assembly x1



2 - Chair Arm (Seated) Left



3 - Chair Arm (Seated) Right



4 - Chair Back x1



5 - Chair Back Cushion x1



6 - Chair Leg x4

### HARDWARE



A - Washer x4

### Assembly Instructions

①

Select and lay Chair Assembly 1. Select 2 Chair Arm(Seated) Left and 3 Chair Arm (Seated) Right insert into hole in Chair Assembly to hand tighten.

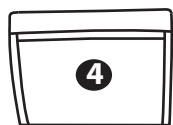
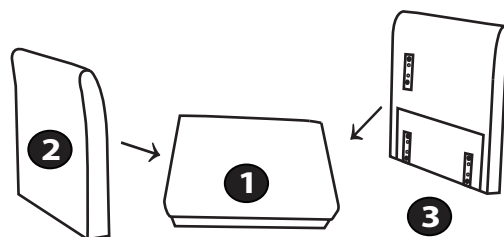

②

Select 4 Chair Back×1, Insert 4 into the 1.



③

Put the 5 Chair Back Cushion on the 1 Chair Assembly to make chair comfortable.

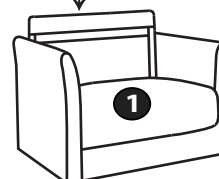

④

Insert A Washer×1 into the 6 Leg ×1.Repeat another A×3 into the another Legs ×3.

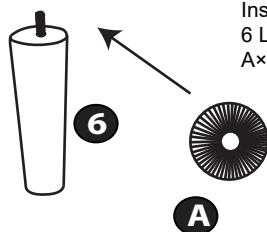

⑤

Insert 6×4 into the button of the 1 Chair Asembly and hand tighten.

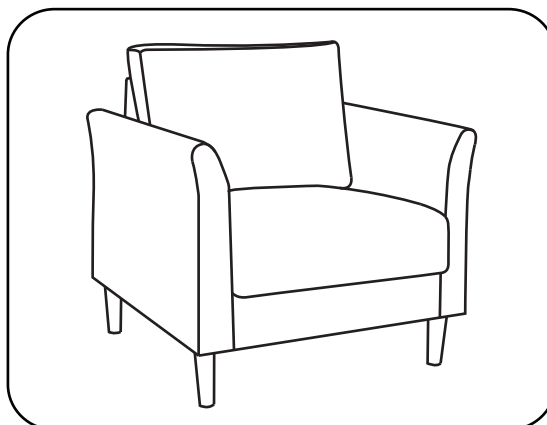
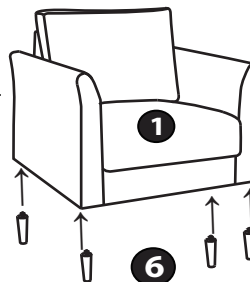

Congratulations! Setup of your new Naomi Home Claire Accent Sofa is Complete!